



Scan by Zenith

TEKTRONIX®

committed to
technical excellence

data sheet

CDG - PARTS PUBLICATION

RACKMOUNT FRAME ASSEMBLY

Part No. 016-0337-00

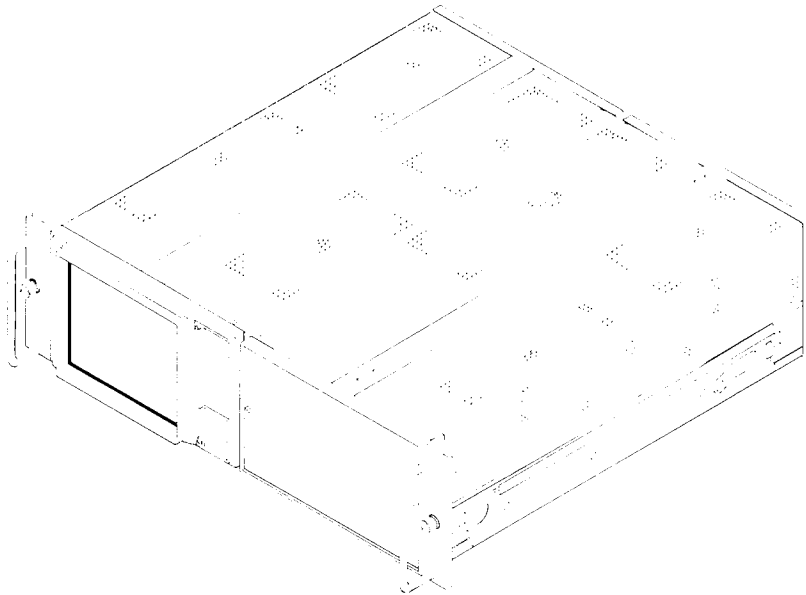

DESCRIPTION

The 016-0337-00 Rackmount Frame Assembly contains all the mechanical parts required to mount a 528 Waveform Monitor and a 603 Storage Monitor or 604 Display Monitor in a standard 19 inch wide rack.

The kit includes three main parts:

1. The frame assembly into which the 528 fits, including hardware for attaching the assembly to the 603/604.
2. The handles and blank panel.
3. The slide-out chassis-tracks.

NO. 062-1835-00

DATE JULY 1975

COPYRIGHT © 1974
TEKTRONIX INC.
ALL RIGHTS RESERVED

ASSEMBLY INSTRUCTIONS

Although the 016-0337-00 may be attached to either side of the 603/604, control positioning on the front panels of the two instruments make an assembly with the 528 to the right of the 603/604 better.

1. Remove the cabinet sides and handle from the 603/604 Monitor.
2. Install a handle assembly on the left side of the 603/604 Monitor and on frame assembly.
3. Install the slide sections of the chassis tracks on the same sides as the handle assemblies.
4. Fasten the 603/604 and the frame assembly together using the spacer plates and associated hardware. The 4-40 rectangular nuts fit in the slots in the spacer plates and protrude through the square holes in the 603/604 and frame assembly sides.
5. Install the cabinet sides and top cover.
6. Install the 528 in the frame assembly.
 - a. Remove the cabinet from the 528.
 - b. Remove the four black plastic rails from the edges of 528 chassis.
 - c. Remove the blank cover from the frame assembly.
 - d. Slide the 528 carefully all the way into the frame assembly. Tolerances are very close. Use care.
 - e. Secure the 528 to the rear securing bracket in the frame assembly using two 8-32 thumb screws and plastic washers.

TRACK INSTALLATION

The slide-out tracks mount to cabinet front and rear rails using universal hole spacing, if the inside distance between front and rear rails is between 10 9/16 inches and 24 3/8 inches. If the inside distance exceeds 24 3/8 inches, extensions must be made to support the rear of the slide-out tracks.

Allow enough space around the 603/604-528 for air circulation, if other instruments are operated in the rack. At least 1/4 inch both above and below, and 2 inches in the rear are required for proper circulation.

The hardware kit contains hardware for mounting the stationary section of the track by two different methods (depending on the type of rack). METHOD 1. The rack rails are tapped to accept 10-32 screws.

The front flanges of the track are mounted on the outside of the rails. The distance between front rails must be at least 17 3/4 inches. For increased bearing surface a flat washer (not supplied) can be added under the screw head. If this method is used, the front panel of the unit to be installed will not fit flush against the rack rail because of the thickness of the washer and track. Method 2. The rack rails are either untapped or countersunk.

The front flanges of the stationary section of the track are mounted behind the front rack rail using bar nuts.

The rear sections of the track can be mounted using either of the methods mentioned. Note that the rear mounting brackets can be mounted pointing forward or backward, depending on whether the rack is deep or shallow.

UNIT INSTALLATION

1. Pull the track intermediate section forward to the fully extended position.
2. Insert the chassis sections into the intermediate sections.
3. Press the stop latches on the chassis sections and push the unit into the rack until the latches snap into their holes.
4. Again press the stop latches and push the unit into the rack.

To adjust the tracks for smooth sliding action, loosen the screws holding the front flanges of the stationary sections. Center the units, allowing the tracks to seek their proper position. Tighten the Screws.

The tracks are specially finished to be permanently lubricated.

SPECIFICATION

Length	48.1 cm	(19.31 in.)
Height	13.27 cm	(5.22 in.)
Width	27.27 cm	(8.375 in.)
Weight (Net)	2.21 kg	(2 lb. 13 oz.)
Weight (Packaged)	6.1 kg	14 lb.)

Replaceable Mechanical Parts

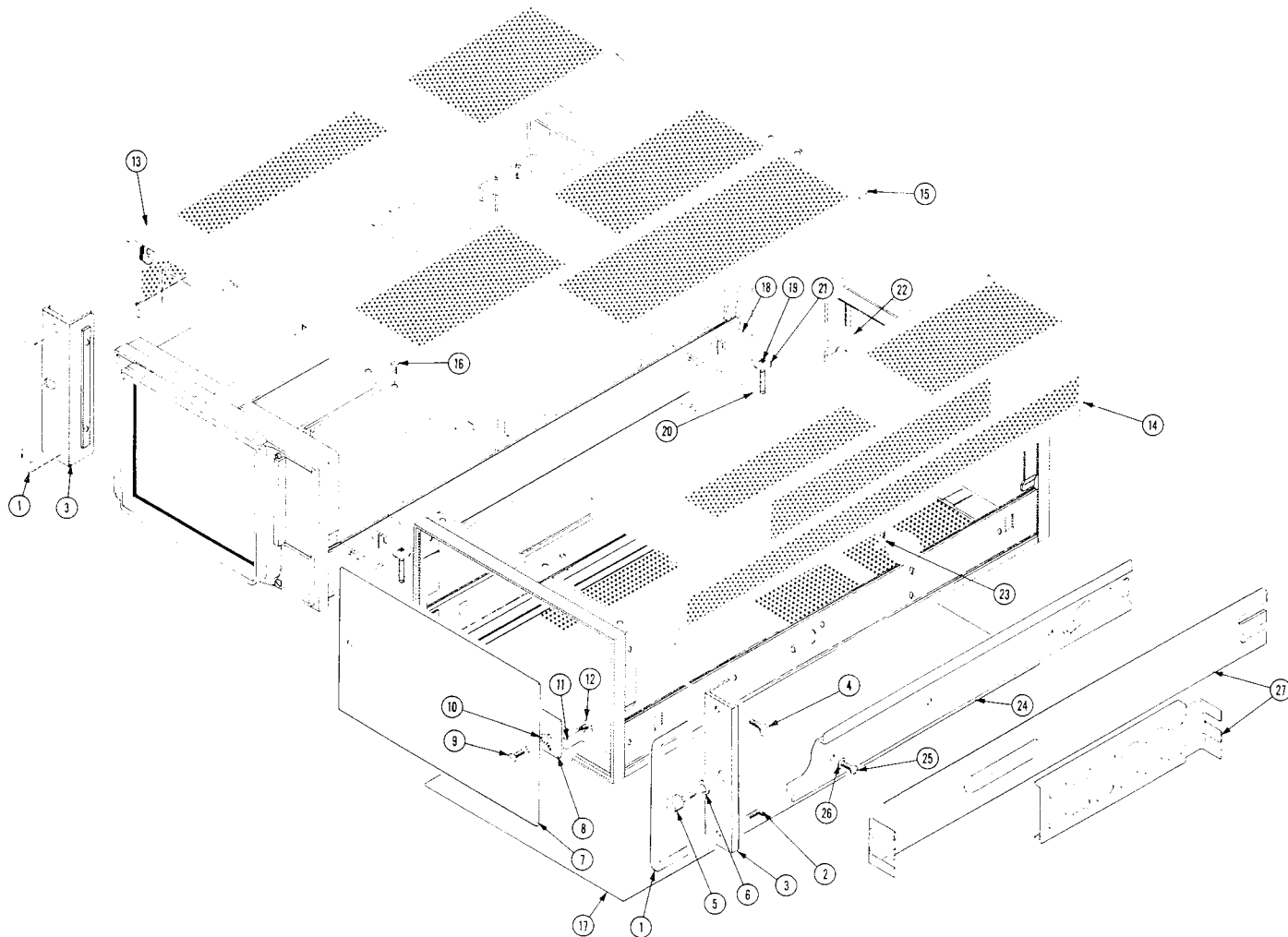

Index No.	Tektronix Part No.	Serial/Model No. Eff	No. Dscont	Qty						Name & Description	Mfr	
					1	2	3	4	5		Code	Mfr Part Number
1-1	367-0008-00			2						HANDLE, BOW: POLISHED NICKEL (ATTACHING PARTS FOR EACH)	71279	X10751
-2	212-0560-00			2						SCREW, MACHINE: 10-32 X 0.312 INCH, FLH STL - - - * - - -	75497	OBD
-3	407-1221-01			2						BRACKET, RACK MT: LEFT AND RIGHT (ATTACHING PARTS FOR EACH)	80009	407-1221-01
-4	212-0070-00			2						SCREW, MACHINE: 8-32 X 0.312" 100 DEG, FLH STL - - - * - - -	83385	OBD
-5	213-0262-00			2						THUMBSCREW: 8-32 THD X 0.45" LONG KNURLED	80009	213-0262-00
-6	210-0894-00			2						WASHER, NONMETAL: 0.19 ID X 0.438" OD, PLSTC	09422	OBD
-7	333-1516-00			1						PANEL, FRONT: 603	80009	333-1516-00
-8	381-0366-00			1						BAR, ADAPTER: FRONT PANEL (ATTACHING PARTS)	80009	381-0366-00
-9	211-0008-00			2						SCREW, MACHINE: 4-40 X 0.25 INCH, PNH STL	83385	OBD
-10	210-0852-00			2						WASHER, FLAT: 0.188 ID X 0.375 OD, 0.91" THK, STL - - - * - - -	12327	OBD

Index No.	Tektronix Part No.	Serial/Model No. Eff	Dscnt	Qty	Name & Description					Mfr	
					1	2	3	4	5	Code	Mfr Part Number
-11	344-0153-00			2	CLIP,SPR TNSN:0.885" LONG X 0.40" WIDE (ATTACHING PARTS)					80009	344-0153-00
-12	211-0007-00			2	SCREW,MACHINE:4-40 X 0.18 INCH,PNH STL - - - * - - -					83385	OBD
-13	390-0271-00			1	COVER,SCOPE:LEFT SIDE					80009	390-0271-00
	214-0603-01			2	. PIN,SECURING:0.27 INCH LONG					80009	214-0603-01
	214-0604-00			2	. WASH.,SPG TNSN:0.26 ID X 0.47 INCH OD					80009	214-0604-00
	386-0227-00			2	. PL,LATCH INDEX:					80009	386-0227-00
	386-0226-00			2	. PL,LATCH LKG:FOR 0.08 INCH THICKNESS					80009	386-0226-00
-14	390-0245-00			1	COVER,SCOPE:RIGHT SIDE					80009	390-0245-00
	214-0603-01			2	. PIN,SECURING:0.27 INCH LONG					80009	214-0603-01
	214-0604-00			2	. WASH.,SPG TNSN:0.26 ID X 0.47 INCH OD					80009	214-0604-00
	386-0227-00			2	. PL,LATCH INDEX:					80009	386-0227-00
	386-0226-00			2	. PL,LATCH LKG:FOR 0.08 INCH THICKNESS					80009	386-0226-00
-15	390-0242-00			1	COVER,SCOPE:TOP (ATTACHING PARTS)					80009	390-0242-00
-16	211-0502-00			4	SCREW,MACHINE:6-32 X 0.188",FLH STL - - - * - - -					83385	OBD
-17	390-0281-00			1	COVER,SCOPE:BOTTOM					80009	390-0281-00
-18	361-0451-00			2	SPACER,RACK MTG:ALUM (ATTACHING PARTS)					80009	361-0451-00
-19	211-0018-00			2	SCREW,MACHINE:4-40 X 0.875 PNH,STL					83385	OBD
-20	220-0634-00			2	NUT,PLAIN,RECT:4-40 X 0.093" THK,STL					80009	220-0634-00
-21	210-0949-00			2	WASHER,FLAT:0.141 ID X 0.50 INCH OD,BRS - - - * - - -					12327	OBD
-22	407-1719-00			1	BRACKET,RACK MT:SECURING (ATTACHING PARTS)					80009	407-1719-00
-23	212-0564-00			2	SCREW,CAP:1-032 X 0.250,BTN HD,STL - - - * - - -					78189	OBD
-24	351-0104-00			PR	SLIDE SECT.,DWR:PAIR (ATTACHING PARTS)					80009	351-0104-00
-25	212-0004-00			6	SCREW,MACHINE:8-32 X 0.312 INCH,PNH STL					83385	OBD
-26	210-0858-00			6	WASHER,FLAT:0.500 OD X 0.171 ID X 0.063 THK - - - * - - -					80009	210-0858-00
-27	351-0195-00			PR	SLIDE,DWR,EXT:SLIDE,PAIR (RACKMOUNT ONLY)					80009	351-0195-00

CROSS INDEX MFR. CODE NUMBER TO MANUFACTURER

MFR.CODE	MANUFACTURER	ADDRESS	CITY,STATE,ZIP
06666	GENERAL DEVICES CO., INC.	525 S. WEBSTER AVE.	INDIANAPOLIS, IN 46219
09422	PLASTIC STAMPING CORP.	2216 W. ARMITAGE AVE.	CHICAGO, IL 60647
12327	FREEWAY CORP.	9301 ALLEN DR.	CLEVELAND, OH 44125
71279	CAMBRIDGE THERMIONIC CORP.	445 CONCORD AVE.	CAMBRIDGE, MA 02138
75497	LAMSON AND SESSIONS CO., THE	5000 TIEDEMAN ROAD	CLEVELAND, OH 44144
78189	ILLINOIS TOOL WORKS, INC.		
	SHAKEPROOF DIVISION	ST. CHARLES ROAD	ELGIN, IL 60120
80009	TEKTRONIX, INC.	P. O. BOX 500	BEAVERTON, OR 97077
83385	CENTRAL SCREW CO.	2530 CRESCENT DR.	BROADVIEW, IL 60153